



City of Westminster

# Licensing Sub-Committee Report

|                    |   |
|--------------------|---|
| Item No:           |   |
| Date:              | 23 May 2019   |
| Licensing Ref No:  | 19/02792/LIPV - Premises Licence Variation  |
| Title of Report:   | Hippodrome Casino<br>The Hippodrome<br>10-14 Cranbourn Street<br>London<br>WC2H 7JH |
| Report of:         | Director of Public Protection and Licensing   |
| Wards involved:    | St James's  |
| Policy context:    | City of Westminster Statement of Licensing Policy                                   |
| Financial summary: | None  |
| Report Author:     | Kevin Jackaman<br>Senior Licensing Officer  |
| Contact details    | Telephone: 0207 641 8094<br>Email: kjackaman@westminster.gov.uk                     |

## 1. Application

| 1-A Applicant and premises        |  |                                |                 |
|-----------------------------------|--|--------------------------------|-----------------|
| <b>Application Type:</b>          | Variation of a Premises Licence, Licensing Act 2003  |                                |                 |
| <b>Application received date:</b> | 7 March 2019   |                                |                 |
| <b>Applicant:</b>                 | Hippodrome Casino Limited  |                                |                 |
| <b>Premises:</b>                  | Hippodrome Casino  |                                |                 |
| <b>Premises address:</b>          | The Hippodrome<br>10-14 Cranbourn Street<br>London<br>WC2H 7JH   | <b>Ward:</b>                   | St James's Ward |
|                                   |  | <b>Cumulative Impact Area:</b> | West End        |
| <b>Premises description:</b>      | The premises trade as a casino providing gaming facilities, the supply of alcohol and regulated entertainment.   |                                |                 |
| <b>Variation description:</b>     | <p>To amend condition 52 to read:</p> <p><b>All sales of alcohol for consumption off the premises are restricted to</b></p> <p><b>(a) Sealed containers of alcohol sold only to invited customers of the Hippodrome Wine Club</b></p> <p><b>(b) Patrons who are gaming within the adjacent Hippodrome Bingo premises supplied only through The Street (as shaded on plan reference LA/P-100 dated May 16) by waiter/waitress service 24 hours a day</b></p>  |                                |                 |
| <b>Premises licence history:</b>  | The premises has had the benefit of a premises licence since 2010. The current premises licence reference is 18/13760 which is attached as Appendix 1 of this report. Please see Appendix 4 of the report for a full licence history   |                                |                 |
| <b>Applicant submissions:</b>     | <p>In response to the representation from the Licensing Authority, the applicant provided the following submissions:</p> <p>This application relates only to off sales of alcohol which can already be made by virtue of the premises licence granted to the Hippodrome casino.</p> <p>The proposal permits the supply of alcohol for consumption off the casino premises, but <b>ONLY</b> to patrons in the next door premises (Crystal Rooms) which is also operated and owned by the Hippodrome Casino.</p> <p>No off sales are permitted outside for consumption in the street. This enables our patrons in the Crystal Rooms to be supplied with alcohol from within the adjacent casino. When we made the original application, it was for 24 hour service in the Crystal Rooms, but Ian Watson pointed out to us that the gambling licence for the Crystal Rooms only operated until midnight. He suggested that as a matter of policy, alcohol supplies ought to run for the same hours as the gambling licence. The current off sales therefore only operate until midnight.</p> <p>We have therefore now varied the gambling licence to 24 hours and seek to have the off sales into the Crystal Rooms to run for the same hours as the gambling licence. Policy 2.5.62 applies.</p> |                                |                 |

| 1-B Current and proposed licensable activities, areas and hours |                  |       |                |      |                          |           |
|---|------------------|-------|----------------|------|--------------------------|-----------|
| Regulated Entertainment   |                  |       |                |      |                          |           |
| Exhibition of films   |                  |       |                |      |                          |           |
|   | Current Hours    |       | Proposed Hours |      | Licensable Area          |           |
|   | Start:           | End:  | Start:         | End: | Current:                 | Proposed: |
| Monday  | 00:01            | 00:00 | No change      |      | Basement to fourth floor | No change |
| Tuesday   | 00:01            | 00:00 |                |      |                          |           |
| Wednesday   | 00:01            | 00:00 |                |      |                          |           |
| Thursday  | 00:01            | 00:00 |                |      |                          |           |
| Friday  | 00:01            | 00:00 |                |      |                          |           |
| Saturday  | 00:01            | 00:00 |                |      |                          |           |
| Sunday  | 00:01            | 00:00 |                |      |                          |           |
| Seasonal Variations/<br>Non-standard timings::                  | Current:<br>None |       |                |      | Proposed:<br>N/A         |           |

| Performance of Dance                           |                  |       |                |      |                          |           |
|--|------------------|-------|----------------|------|--------------------------|-----------|
|  | Current Hours    |       | Proposed Hours |      | Licensable Area          |           |
|  | Start:           | End:  | Start:         | End: | Current:                 | Proposed: |
| Monday   | 00:01            | 00:00 | No change      |      | Basement to fourth floor | No change |
| Tuesday  | 00:01            | 00:00 |                |      |                          |           |
| Wednesday                                      | 00:01            | 00:00 |                |      |                          |           |
| Thursday                                       | 00:01            | 00:00 |                |      |                          |           |
| Friday   | 00:01            | 00:00 |                |      |                          |           |
| Saturday                                       | 00:01            | 00:00 |                |      |                          |           |
| Sunday   | 00:01            | 00:00 |                |      |                          |           |
| Seasonal Variations/<br>Non-standard timings:: | Current:<br>None |       |                |      | Proposed:<br>N/A         |           |

| Indoor Sporting Event                          |                  |       |                |      |                          |           |
|--|------------------|-------|----------------|------|--------------------------|-----------|
|  | Current Hours    |       | Proposed Hours |      | Licensable Area          |           |
|  | Start:           | End:  | Start:         | End: | Current:                 | Proposed: |
| Monday   | 00:01            | 00:00 | No change      |      | Basement to fourth floor | No change |
| Tuesday  | 00:01            | 00:00 |                |      |                          |           |
| Wednesday                                      | 00:01            | 00:00 |                |      |                          |           |
| Thursday                                       | 00:01            | 00:00 |                |      |                          |           |
| Friday   | 00:01            | 00:00 |                |      |                          |           |
| Saturday                                       | 00:01            | 00:00 |                |      |                          |           |
| Sunday   | 00:01            | 00:00 |                |      |                          |           |
| Seasonal Variations/<br>Non-standard timings:: | Current:<br>None |       |                |      | Proposed:<br>N/A         |           |

| Performance of Live Music                      |                  |       |                |      |                          |           |
|--|------------------|-------|----------------|------|--------------------------|-----------|
|  | Current Hours    |       | Proposed Hours |      | Licensable Area          |           |
|  | Start:           | End:  | Start:         | End: | Current:                 | Proposed: |
| Monday   | 00:01            | 00:00 | No change      |      | Basement to fourth floor | No change |
| Tuesday  | 00:01            | 00:00 |                |      |                          |           |
| Wednesday                                      | 00:01            | 00:00 |                |      |                          |           |
| Thursday                                       | 00:01            | 00:00 |                |      |                          |           |
| Friday   | 00:01            | 00:00 |                |      |                          |           |
| Saturday                                       | 00:01            | 00:00 |                |      |                          |           |
| Sunday   | 00:01            | 00:00 |                |      |                          |           |
| Seasonal Variations/<br>Non-standard timings:: | Current:<br>None |       |                |      | Proposed:<br>N/A         |           |

| Recorded Music                                 |                  |       |                |      |                          |           |
|--|------------------|-------|----------------|------|--------------------------|-----------|
|  | Current Hours    |       | Proposed Hours |      | Licensable Area          |           |
|  | Start:           | End:  | Start:         | End: | Current:                 | Proposed: |
| Monday   | 00:01            | 00:00 | No change      |      | Basement to fourth floor | No change |
| Tuesday  | 00:01            | 00:00 |                |      |                          |           |
| Wednesday                                      | 00:01            | 00:00 |                |      |                          |           |
| Thursday                                       | 00:01            | 00:00 |                |      |                          |           |
| Friday   | 00:01            | 00:00 |                |      |                          |           |
| Saturday                                       | 00:01            | 00:00 |                |      |                          |           |
| Sunday   | 00:01            | 00:00 |                |      |                          |           |
| Seasonal Variations/<br>Non-standard timings:: | Current:<br>None |       |                |      | Proposed:<br>N/A         |           |

| Anything of a similar description to Live Music, Recorded Music or Performance of Dance |                  |       |                |      |                          |           |
|---|------------------|-------|----------------|------|--------------------------|-----------|
|   | Current Hours    |       | Proposed Hours |      | Licensable Area          |           |
|   | Start:           | End:  | Start:         | End: | Current:                 | Proposed: |
| Monday  | 00:01            | 00:00 | No change      |      | Basement to fourth floor | No change |
| Tuesday   | 00:01            | 00:00 |                |      |                          |           |
| Wednesday   | 00:01            | 00:00 |                |      |                          |           |
| Thursday  | 00:01            | 00:00 |                |      |                          |           |
| Friday  | 00:01            | 00:00 |                |      |                          |           |
| Saturday  | 00:01            | 00:00 |                |      |                          |           |
| Sunday  | 00:01            | 00:00 |                |      |                          |           |
| Seasonal Variations/<br>Non-standard timings::  | Current:<br>None |       |                |      | Proposed:<br>N/A         |           |

| Performance of a play                          |                  |       |                |      |                          |           |
|--|------------------|-------|----------------|------|--------------------------|-----------|
|  | Current Hours    |       | Proposed Hours |      | Licensable Area          |           |
|  | Start:           | End:  | Start:         | End: | Current:                 | Proposed: |
| Monday   | 00:01            | 00:00 | No change      |      | Basement to fourth floor | No change |
| Tuesday  | 00:01            | 00:00 |                |      |                          |           |
| Wednesday                                      | 00:01            | 00:00 |                |      |                          |           |
| Thursday                                       | 00:01            | 00:00 |                |      |                          |           |
| Friday   | 00:01            | 00:00 |                |      |                          |           |
| Saturday                                       | 00:01            | 00:00 |                |      |                          |           |
| Sunday   | 00:01            | 00:00 |                |      |                          |           |
| Seasonal Variations/<br>Non-standard timings:: | Current:<br>None |       |                |      | Proposed:<br>N/A         |           |

| Late night refreshment                         |                  |       |                |      |                          |           |
|--|------------------|-------|----------------|------|--------------------------|-----------|
| Indoors, outdoors or both                      |                  |       | Current :      |      |                          | Proposed: |
|  |                  |       | Both           |      |                          | No change |
|  | Current Hours    |       | Proposed Hours |      | Licensable Area          |           |
|  | Start:           | End:  | Start:         | End: | Current:                 | Proposed: |
| Monday   | 23:00            | 05:00 | No change      |      | Basement to fourth floor | No change |
| Tuesday  | 23:00            | 05:00 |                |      |                          |           |
| Wednesday                                      | 23:00            | 05:00 |                |      |                          |           |
| Thursday                                       | 23:00            | 05:00 |                |      |                          |           |
| Friday   | 23:00            | 05:00 |                |      |                          |           |
| Saturday                                       | 23:00            | 05:00 |                |      |                          |           |
| Sunday   | 23:00            | 05:00 |                |      |                          |           |
| Seasonal Variations/<br>Non-standard timings:: | Current:<br>None |       |                |      | Proposed:<br>N/A         |           |

| Sale by Retail of Alcohol                      |                  |       |                |      |                          |           |
|--|------------------|-------|----------------|------|--------------------------|-----------|
|  | Current Hours    |       | Proposed Hours |      | Licensable Area          |           |
|  | Start:           | End:  | Start:         | End: | Current:                 | Proposed: |
| Monday   | 00:01            | 00:00 | No change      |      | Basement to fourth floor | No change |
| Tuesday  | 00:01            | 00:00 |                |      |                          |           |
| Wednesday                                      | 00:01            | 00:00 |                |      |                          |           |
| Thursday                                       | 00:01            | 00:00 |                |      |                          |           |
| Friday   | 00:01            | 00:00 |                |      |                          |           |
| Saturday                                       | 00:01            | 00:00 |                |      |                          |           |
| Sunday   | 00:01            | 00:00 |                |      |                          |           |
| Seasonal Variations/<br>Non-standard timings:: | Current:<br>None |       |                |      | Proposed:<br>N/A         |           |

| Hours premises are open to the public              |                         |       |                |      |                          |           |
|--|-------------------------|-------|----------------|------|--------------------------|-----------|
|  | Current Hours           |       | Proposed Hours |      | Licensable Area          |           |
|  | Start:                  | End:  | Start:         | End: | Current:                 | Proposed: |
| <b>Monday</b>                                      | 00:01                   | 00:00 | No change      |      | Basement to fourth floor | No change |
| <b>Tuesday</b>                                     | 00:01                   | 00:00 |                |      |                          |           |
| <b>Wednesday</b>                                   | 00:01                   | 00:00 |                |      |                          |           |
| <b>Thursday</b>                                    | 00:01                   | 00:00 |                |      |                          |           |
| <b>Friday</b>                                      | 00:01                   | 00:00 |                |      |                          |           |
| <b>Saturday</b>                                    | 00:01                   | 00:00 |                |      |                          |           |
| <b>Sunday</b>                                      | 00:01                   | 00:00 |                |      |                          |           |
| <b>Seasonal Variations/ Non-standard timings::</b> | <b>Current:</b><br>None |       |                |      | <b>Proposed:</b><br>N/A  |           |

| 1-C Layout alteration |
|-----------------------|
| No change             |

| 1-D Conditions proposed to be varied by the Applicant  |   |
|--|---|
| Condition  | Proposed variation  |
| Condition 52: All sales of alcohol for consumption "off" the premises is restricted to:<br>(a) Sealed containers sold to invited customers of the Hippodrome Wine Club<br>(b) Patrons who are gaming within the adjacent Hippodrome Bingo premises supplied only through The Street (as shaded on plan reference LA/P-100 dated May 2016) by waiter/waitress service between 09:00 and 00:00 Hours (midnight) Monday to Sunday | Condition 52: All sales of alcohol for consumption "off" the premises is restricted to:<br>(a) Sealed containers sold to invited customers of the Hippodrome Wine Club<br>(b) Patrons who are gaming within the adjacent Hippodrome Bingo premises supplied only through The Street (as shaded on plan reference LA/P-100 dated May 2016) by waiter/waitress service 24 hours per day |

## 2. Representations

| 2-A Responsible Authorities  |  |
|--|--|
| <b>Responsible Authority:</b>  | Licensing Authority ( <b>withdrawn</b> ) |
| <b>Representative:</b>   | Roxanna Haq                              |
| <b>Received:</b>   | 4 April 2019                             |
| <p>I write in relation to the application submitted for the variation of a Premises Licence for: <b>19/02792/LIPV: Hippodrome Casino, 10-14 Cranbourn Street, London, WC2H 7JH</b></p> <p>As a responsible authority under section 13 (4) of the Licensing Act 2003 as amended under the Police and Social Responsibility Act 2011, the Licensing Authority have considered your application in full. The Licensing Authority has concerns in relation to this application and how the premises would promote the Licensing Objectives:</p> <ul style="list-style-type: none"><li>· Public Nuisance</li><li>· Prevention of Crime &amp; Disorder</li><li>· Public Safety</li><li>· Protection of children from harm</li></ul> <p>This application seeks the following:</p> <p>To amend condition 52 which currently reads;<br/>All sales of alcohol for consumption 'Off' the premises is restricted to;<br/>(a) Sealed containers sold only to invited customers of the Hippodrome Wine Club<br/>(b) Patrons who are gaming within the adjacent Hippodrome Bingo premises supplied only through The Street (as shaded on plan reference LA/P-100 dated May 16) by waiter/waitress service between 09.00 hours and 00.00 hours (Midnight) Monday to Sunday.</p> <p>Proposed condition:<br/>All sales of alcohol for consumption 'Off' the premises is restricted to;<br/>(a) Sealed containers sold only to invited customers of the Hippodrome Wine Club<br/>(b) Patrons who are gaming within the adjacent Hippodrome Bingo premises supplied only through The Street (as shaded on plan reference LA/P-100 dated May 16) by waiter/waitress service 24 hours per day.</p> <p>The premises is located within the West End Cumulative Impact area and as such policy points CIP1, and HRS1 and OS2 must be considered.<br/>The core hour's policy as defined in HRS1 state the hours for the supply of alcohol off the premises and these are:<br/>Monday- Saturday 08:00 - 23:00 hours<br/>Sunday 10:00 - 22:30 hours.</p> <p>The application as it stands falls outside of these hours as the proposed hours are beyond the Councils core hours' policy and this application would significantly increase the existing hours for off sales.<br/>Furthermore, the applicant must demonstrate that they will not add to cumulative impact in the Cumulative Impact Area. Unless the applicant can satisfy the concerns of the Licensing Authority by demonstrating that this application will not add to cumulative impact if granted, it will be for Licensing Sub-Committee Members to determine this application, given its location within the West End Cumulative Impact area.</p> <p>Please accept this as a formal representation and we look forward to receiving any further submissions which will be forwarded on for Members information.</p> <p><b>Following further submissions and discussions with the applicant, the Licensing Authority representation was withdrawn on 8 April</b></p> |  |

|   |                             |
|---|-----------------------------|
| <b>Responsible Authority:</b>   | Metropolitan Police Service |
| <b>Representative:</b>  | Bryan Lewis                 |
| <b>Received:</b>  | 29 March 2019               |
| <p>With reference to the above application, I am writing to inform you that the Metropolitan Police, as a Responsible Authority, is objecting to this application as it is our belief that if granted this application would undermine the Licensing Objectives.</p> <p>The venue is located in the West End Cumulative Impact Area, a locality where there is traditionally high levels of crime and disorder. We have concerns that this application will cause further policing problems in an already demanding area.</p> |                             |

### 3. Policy & Guidance

|  |   |
|--|---|
| The following policies within the City Of Westminster Statement of Licensing Policy apply: |   |
| <b>Policy CP1 applies</b>  | <p>(i) It is the Licensing Authority's policy to refuse applications in the Cumulative Impact Areas for: pubs and bars, fast food premises, and premises offering facilities for music and dancing; other than applications to vary hours within the Core Hours under Policy HRS1.</p> <p>(ii) Applications for other licensable activities in the Cumulative Impact Areas will be subject to other policies, and must demonstrate that they will not add to cumulative impact in the Cumulative Impact Areas.</p>  |
| <b>Policy HRS1 applies</b>   | <p>(i) Applications for hours within the core hours set out below in this policy will generally be granted, subject to not being contrary to other policies in the Statement of Licensing Policy.</p> <p>(ii) Applications for hours outside the core hours set out below in this policy will be considered on their merits, subject to other relevant policies.</p> <p><u>For premises for the supply of alcohol for consumption on the premises:</u><br/> Monday to Thursday: 10:00 to 23:30<br/> Friday and Saturday: 10:00 to midnight<br/> Sundays immediately prior to Bank Holidays: Midday to midnight<br/> Other Sundays: Midday to 22:30</p> <p><u>For premises for the provision of other licensable activities:</u><br/> Monday to Thursday: 09:00 to 23.30<br/> Friday and Saturday: 09:00 to midnight<br/> Sundays immediately prior to Bank Holidays: 09:00 to midnight<br/> Other Sundays: 09:00 to 22:30</p> |
| <b>Policy CAS1 applies</b>   | The inclusion of regulated entertainment and extension of the hours for the sale of alcohol ancillary to the playing of casino games in casinos will be considered in relation to the likely effect on the licensing objectives.  |



#### 4. Equality Implications

The Council in its capacity as Licensing Authority has a duty to have regard to its public sector equality duty under section 149 of the Equality Act 2010. In summary, section 149 provides that a Public Authority must, in the exercise of its functions, have due regard to the need to:

- (a) eliminate discrimination harassment, victimisation and any other conduct that is prohibited by or under this Act;
- (b) advance equality of opportunity between persons who share a relevant protected characteristic and persons who do not share it; and
- (c) foster good relations between persons who share a relevant protected characteristics and persons who do not share it.

Section 149 (7) of the Equality Act 2010 defines the relevant protected characteristics as age, disability, gender reassignment, pregnancy and maternity, race, religion or belief, sex, and sexual orientation.

#### 5. Appendices

|                   |  |
|-------------------|--|
| <b>Appendix 1</b> | Current Premises Licence                               |
| <b>Appendix 2</b> | Applicant supporting documents                         |
| <b>Appendix 3</b> | Documents submitted by the Metropolitan Police Service |
| <b>Appendix 4</b> | Premises history                                       |
| <b>Appendix 5</b> | Proposed conditions                                    |
| <b>Appendix 6</b> | Residential map and list of premises in the vicinity   |

|                       |   |
|-----------------------|---|
| <b>Report author:</b> | Kevin Jackaman<br>Senior Licensing Officer                      |
| <b>Contact:</b>       | Telephone: 0207 641 8094<br>Email: kjackaman@westminster.gov.uk |

**If you have any queries about this report or wish to inspect one of the background papers please contact the report author.**

#### **Background Documents – Local Government (Access to Information) Act 1972**

|          |   |                |
|----------|---|----------------|
| <b>1</b> | Licensing Act 2003  | N/A            |
| <b>2</b> | City of Westminster Statement of Licensing Policy                   | 7 January 2016 |
| <b>3</b> | Amended Guidance issued under section 182 of the Licensing Act 2003 | April 2018     |
| <b>4</b> | Licensing Authority Representation (withdrawn 8 April 2019)         | 4 April        |
| <b>5</b> | Metropolitan Police Service Representation                          | 29 March 2019  |

Schedule 12  
Part AWARD: St James's  
UPRN: 010033600458

## City of Westminster

Premises licence

Regulation 33, 34

Premises licence number:

18/13760/LIPVM

Original Reference:

10/03842/LIPN

## Part 1 – Premises details

## Postal address of premises:

Hippodrome Casino  
The Hippodrome  
10-14 Cranbourn Street  
London  
WC2H 7JH

Telephone Number: Not Supplied

## Where the licence is time limited, the dates:

Not applicable

## Licensable activities authorised by the licence:

Performance of Dance  
Exhibition of a Film  
Indoor Sporting Event  
Performance of Live Music  
Playing of Recorded Music  
Anything of a similar description to Live Music, Recorded Music or Performance of Dance  
Performance of a Play  
Late Night Refreshment  
Sale by Retail of Alcohol

## The times the licence authorises the carrying out of licensable activities:

**Performance of Dance**

Monday to Sunday: 00:01 to 00:00

**Exhibition of a Film**

Monday to Sunday: 00:01 to 00:00

**Indoor Sporting Event**

Monday to Sunday: 00:01 to 00:00

**Performance of Live Music**

Monday to Sunday: 00:01 to 00:00

**Playing of Recorded Music**

Monday to Sunday: 00:01 to 00:00

**Anything of a similar description to Live Music, Recorded Music or Performance of Dance**

Monday to Sunday: 00:01 to 00:00

**Performance of a Play**

Monday to Sunday: 00:01 to 00:00

**Late Night Refreshment**

Monday to Sunday: 23:00 to 05:00

**Sale by Retail of Alcohol**

Monday to Sunday:  
00:01 to 00:00

**The opening hours of the premises:**

Monday to Sunday: 00:01 to 00:00

**Where the licence authorises supplies of alcohol, whether these are on and/or off supplies:**

Alcohol is supplied for consumption on the Premises and off the premises as per condition 52 only.

**Part 2**

**Name, (registered) address, telephone number and email (where relevant) of holder of premises licence:**

Hippodrome Casino Limited  
Hippodrome Casino  
Cranbourne Street  
Leicester Square  
London  
WC2H 7JH  
*Electronic Mail : josh.edwins@hippodromecasino.com*

**Registered number of holder, for example company number, charity number (where applicable)**

05497987

**Name, address and telephone number of designated premises supervisor where the premises licence authorises the supply of alcohol:**

**Name:** Iain Stuart Peebles

***Please note: It is the policy of the Licensing Authority not to display the address details of a designated premises supervisor.***

**Personal licence number and issuing authority of personal licence held by designated premises supervisor where the premises licence authorises for the supply of alcohol:**

|   |
|---|
| <b>Licence Number:</b> 020050461<br><b>Licensing Authority:</b> Ashford Borough Council |
|---|

**Date:** 25 March 2019

**This licence has been authorised by Mr Kevin Jackaman on behalf of the Director -  
Public Protection and Licensing.**

## Annex 1 – Mandatory conditions

1. No supply of alcohol may be made at a time when there is no designated premises supervisor in respect of this licence.
2. No supply of alcohol may be made at a time when the designated premises supervisor does not hold a personal licence or the personal licence is suspended.
3. Every supply of alcohol under this licence must be made or authorised by a person who holds a personal licence.
4.
  - (1) The responsible person must ensure that staff on relevant premises do not carry out, arrange or participate in any irresponsible promotions in relation to the premises.
  - (2) In this paragraph, an irresponsible promotion means any one or more of the following activities, or substantially similar activities, carried on for the purpose of encouraging the sale or supply of alcohol for consumption on the premises—
    - (a) games or other activities which require or encourage, or are designed to require or encourage, individuals to;
      - (i) drink a quantity of alcohol within a time limit (other than to drink alcohol sold or supplied on the premises before the cessation of the period in which the responsible person is authorised to sell or supply alcohol), or
      - (ii) drink as much alcohol as possible (whether within a time limit or otherwise);
    - (b) provision of unlimited or unspecified quantities of alcohol free or for a fixed or discounted fee to the public or to a group defined by a particular characteristic in a manner which carries a significant risk of undermining a licensing objective;
    - (c) provision of free or discounted alcohol or any other thing as a prize to encourage or reward the purchase and consumption of alcohol over a period of 24 hours or less in a manner which carries a significant risk of undermining a licensing objective;
    - (d) selling or supplying alcohol in association with promotional posters or flyers on, or in the vicinity of, the premises which can reasonably be considered to condone, encourage or glamorise anti-social behaviour or to refer to the effects of drunkenness in any favourable manner;
    - (e) dispensing alcohol directly by one person into the mouth of another (other than where that other person is unable to drink without assistance by reason of a disability).
5. The responsible person must ensure that free potable water is provided on request to customers where it is reasonably available.
6.
  - (1) The premises licence holder or club premises certificate holder must ensure that an age verification policy is adopted in respect of the premises in relation to the sale or supply of alcohol.
  - (2) The designated premises supervisor in relation to the premises licence must ensure that the supply of alcohol at the premises is carried on in accordance with the age verification policy.

- (3) The policy must require individuals who appear to the responsible person to be under 18 years of age (or such older age as may be specified in the policy) to produce on request, before being served alcohol, identification bearing their photograph, date of birth and either—
- (a) a holographic mark, or
  - (b) an ultraviolet feature.
7. The responsible person must ensure that—
- (a) where any of the following alcoholic drinks is sold or supplied for consumption on the premises (other than alcoholic drinks sold or supplied having been made up in advance ready for sale or supply in a securely closed container) it is available to customers in the following measures—
    - (i) beer or cider: ½ pint;
    - (ii) gin, rum, vodka or whisky: 25 ml or 35 ml; and
    - (iii) still wine in a glass: 125 ml;
  - (b) these measures are displayed in a menu, price list or other printed material which is available to customers on the premises; and
  - (c) where a customer does not in relation to a sale of alcohol specify the quantity of alcohol to be sold, the customer is made aware that these measures are available.

A responsible person in relation to a licensed premises means the holder of the premise licence in respect of the premises, the designated premises supervisor (if any) or any individual aged 18 or over who is authorised by either the licence holder or designated premises supervisor. For premises with a club premises certificate, any member or officer of the club present on the premises in a capacity that which enables him to prevent the supply of alcohol.

8(i) A relevant person shall ensure that no alcohol is sold or supplied for consumption on or off the premises for a price which is less than the permitted price.

8(ii) For the purposes of the condition set out in paragraph 8(i) above -

- (a) "duty" is to be construed in accordance with the Alcoholic Liquor Duties Act 1979;
- (b) "permitted price" is the price found by applying the formula -

$$P = D + (D \times V)$$

Where -

- (i) P is the permitted price,
  - (ii) D is the amount of duty chargeable in relation to the alcohol as if the duty were charged on the date of the sale or supply of the alcohol, and
  - (iii) V is the rate of value added tax chargeable in relation to the alcohol as if the value added tax were charged on the date of the sale or supply of the alcohol;
- (c) "relevant person" means, in relation to premises in respect of which there is in force a premises licence -
- (i) the holder of the premises licence,

- (ii) the designated premises supervisor (if any) in respect of such a licence, or
    - (iii) the personal licence holder who makes or authorises a supply of alcohol under such a licence;
  - (d) "relevant person" means, in relation to premises in respect of which there is in force a club premises certificate, any member or officer of the club present on the premises in a capacity which enables the member or officer to prevent the supply in question; and
  - (e) "value added tax" means value added tax charged in accordance with the Value Added Tax Act 1994.
- 8(iii). Where the permitted price given by Paragraph 8(ii)(b) above would (apart from this paragraph) not be a whole number of pennies, the price given by that sub-paragraph shall be taken to be the price actually given by that sub-paragraph rounded up to the nearest penny.
- 8(iv). (1) Sub-paragraph 8(iv)(2) below applies where the permitted price given by Paragraph 8(ii)(b) above on a day ("the first day") would be different from the permitted price on the next day ("the second day") as a result of a change to the rate of duty or value added tax.
- (2) The permitted price which would apply on the first day applies to sales or supplies of alcohol which take place before the expiry of the period of 14 days beginning on the second day.
9. All persons guarding premises unauthorised access or occupation or against outbreaks of disorder or against damage (door supervisors) must be licensed by the Security Industry Authority).
10. Admission of children to the premises must be restricted in accordance with the film classification recommended by the British Board of Film Classification or recommended by this licensing authority as appropriate.

## **Annex 2 – Conditions consistent with the operating Schedule**

11. Where regulated entertainment involves special effects such as lasers or pyrotechnics, seven days prior notice shall be given to Westminster City Council Environmental Health Consultation Team.
12. Door Supervisors will be deployed at the premises to monitor the entry and exit points whenever the premises are open after 21:00 hours.
13. The premises shall comply with the appropriate provisions of the DSA Technical Standards for Places of Entertainment.
14. Any Premises Licence granted under the Licensing Act 2003 in respect of this application (number 10/03842/LIPN) shall have no effect unless a Casino Licence is in force and any such Premises Licence shall be surrendered to the Licensing Authority if the Gaming Licence is no longer in force.
15. A personal licence holder shall be on duty at the premises at all times when licensable activities are taking place.
16. The sale and supply of alcohol and the provision of regulated entertainment shall be secondary to the provision of casino facilities.
17. The supply of alcohol to the tables on the first floor will be by Waiter/waitress service, save for tables in the bar area.
18. Substantial food and suitable beverages other than alcohol shall be available where licensable activities are taking place.
19. The number of persons accommodated at any one time (including staff) shall not exceed the following:  
4th floor card deck: 110 persons  
Auditorium Balcony: 60 persons  
Cabaret balcony: 110 persons  
1st Floor Cabaret: 240 persons  
Remaining parts of premises: 2010 persons

With a maximum capacity of 2530 persons (including staff) at any one time.

20. The operators of the business and/or the licensees shall ensure that any capacity limits set for the premises is properly monitored at all times. Information regarding the capacity shall be given to an authorised officer or Police Officer on request.
21. An attendant shall be on duty in the cloakroom during the whole time that it is in use.
22. A minimum of two door supervisors shall be on duty at all times when licensable activities are taking place.
23. The premises licence holder shall ensure that any queue to enter the premises which forms outside the premises is orderly and supervised by door staff so as to ensure that there is no public nuisance or obstruction to the public highway.
24. The venue will maintain a comprehensive CCTV system that ensures all parts of the licensed premises are monitored, including all entry and exit points and the street environment including the identification of every person entering in any light condition. All such cameras, that are not unique to casinos, required and approved by the Police and Licensing Authority shall continually record whilst the premises are open to the public and the recordings shall be retained and made available for 31 days with time and date stamping. Recordings shall be made available to an authorised officer or a



Police officer together with facilities for viewing. The recordings for the preceding two days shall be made available on request. Recordings outside this period shall be made available at 24 hours notice. All recording imagery that is unique to casinos such as gaming surveillance and cash desk imagery will be retained for the periods prescribed by the Gambling Commission or in the absence of a defined time, in accordance with the existing procedure. Where there is doubt or overlap the longest period will apply. (Subject to Data Protection Act 1998).

25. A staff member from the premises who is conversant with the operation of the CCTV system shall be on the premises at all times when the premises are open to the public. This staff member shall be capable of showing Police recent data or footage with the absolute minimum of delay when required to do so.
26. Loudspeakers shall not be located in the entrance lobby areas.
27. Noise and/or vibration emanating from the premises or transmitted through the structure shall not be audible beyond the boundary of the premises at any time.
28. Notices shall be prominently displayed at exits requesting the public to respect the needs of local residents and to leave the premises and the area quietly.
29. The means of escape provided for the premises shall at all times be maintained unobstructed, free of trip hazards, be immediately available and clearly identified in accordance with the plans provided.
30. The approved arrangements at the premises, including means of escape provisions, emergency warning equipment, the electrical installation and mechanical equipment, shall at all times be maintained in good condition and full working order.
31. All exit doors shall be available at all times without the use of a key, code, card or similar means.
32. All emergency doors shall be maintained effectively self closing and not held open other than by an approved device.
33. The edges of the treads of steps and stairways shall be marked and maintained so as to be conspicuous at all times.
34. Curtains and hangings shall be arranged so as not to obstruct emergency signs.
35. The certificates listed below shall be submitted to the Licensing Authority upon written request.  
  
Any emergency lighting battery or system certificate  
Any electrical installation certificate  
Any emergency warning system certificate
36. Any special effects or mechanical installations shall be arranged and stored so as to minimise any risk to the safety of those using the premises. The following special effects will only be used on 10 days prior notice being given to the Licensing Authority where consent has not previously been given.
  - dry ice and cryogenic fog
  - smoke machines and fog generators
  - pyrotechnics including fire works
  - firearms
  - lasers
  - explosives and highly flammable substances
  - real flame
  - strobe lighting

37. Flashing or particularly bright lights on or outside the premises shall not cause a nuisance to nearby properties (save insofar as they are necessary for the prevention of crime).
38. No person shall give at the premises any exhibition, demonstration or performance of hypnotism, mesmerism or any similar act or process which produces or is intended to produce in any other person any form of induced sleep or trance in which susceptibility of the mind of that person to suggestion or direction is increased or intended to be increased.

NOTE: (1) This rule does not apply to exhibitions given under the provisions of Section 2(1A) and 5 of the Hypnotism Act 1952.

39. All waste is to be properly presented and placed out for collection no earlier than 30 minutes before the scheduled collection times.
40. No refuse, including bottles, shall be moved, removed or transferred to or in outside areas between 2300 hours and 0800 hours.
41. All private and corporate events in the VIP rooms on the 3rd Floor and the private dining areas on the 2nd floor with more than 60 guests will be notified to Westminster Licensing Police giving a minimum of 10 working days notice. All such notifications shall include the following information: the date and time of the event, the duration of the event and the name of the organiser of the event. All such events shall not take place if so instructed by the Police.
42. Uniformed employees of the premises licence holder may be permitted to distribute flyers or leaflets advertising or promoting the premises or any of its events, facilities, goods or services, within 25 metres of any entrance to the Hippodrome Casino, but shall not do so in a manner which may cause an obstruction of the highway nor a nuisance to any passer-by.
43. The pavement within 25 metres of the entrances to the premises shall be kept free of litter or debris arising from the premises and its operation at all times to the satisfaction of the Council.
44. No flyers to be distributed after 21.00 hours or before 08.00 hours.
45. Any flyers distributed outside the premises shall contain no reference to any activity licensed at the premises for the purposes of the Sexual Entertainment licence.
46. Distributors of the flyers will operate a "Think 25" policy.
47. No more than two persons may distribute flyers at any one time.
48. No un-authorized advertisements of any kind (including placard, poster, sticker, flyer, picture, letter, sign or other mark) is inscribed or affixed upon the surface of the highway, or upon any building, structure, works, street furniture, tree, or any other property, or is distributed outside the premises to the public, that advertises or promotes the establishment, its premises, or any of its events, facilities, goods or services.
49. Gaming may take place in the basement and on ground, first, second, third and fourth floors. Cabaret will be limited to the designated area on the first floor. Designated restaurant and dining areas are located on first, second and third floors.
50. All alcohol served in the restaurant will be ancillary to food.

51. The variation of the Premises Licence (14/07918/LIPV) to include (addition of double entrance doors to the lounge) will have no effect until the premises have been assessed as satisfactory by the Environmental Health Consultation Team and this condition has been removed from the Licence.
52. All sales of alcohol for consumption 'Off' the premises is restricted to;
  - (a) Sealed containers sold only to invited customers of the Hippodrome Wine Club
  - (b) Patrons who are gaming within the adjacent Hippodrome Bingo premises supplied only through The Street (as shaded on plan reference LA/P-100 dated May 16) by waiter/waitress service between 09.00 hours and 00.00 hours (Midnight) Monday to Sunday.
53. Patrons permitted to temporarily leave and then re-enter The Hippodrome Casino or Hippodrome Bingo, e.g. to smoke, shall not be permitted to take drinks or glass containers with them.

**Annex 3 - Conditions attached after a hearing by the licensing authority**

None

# Annex 4 - Plans

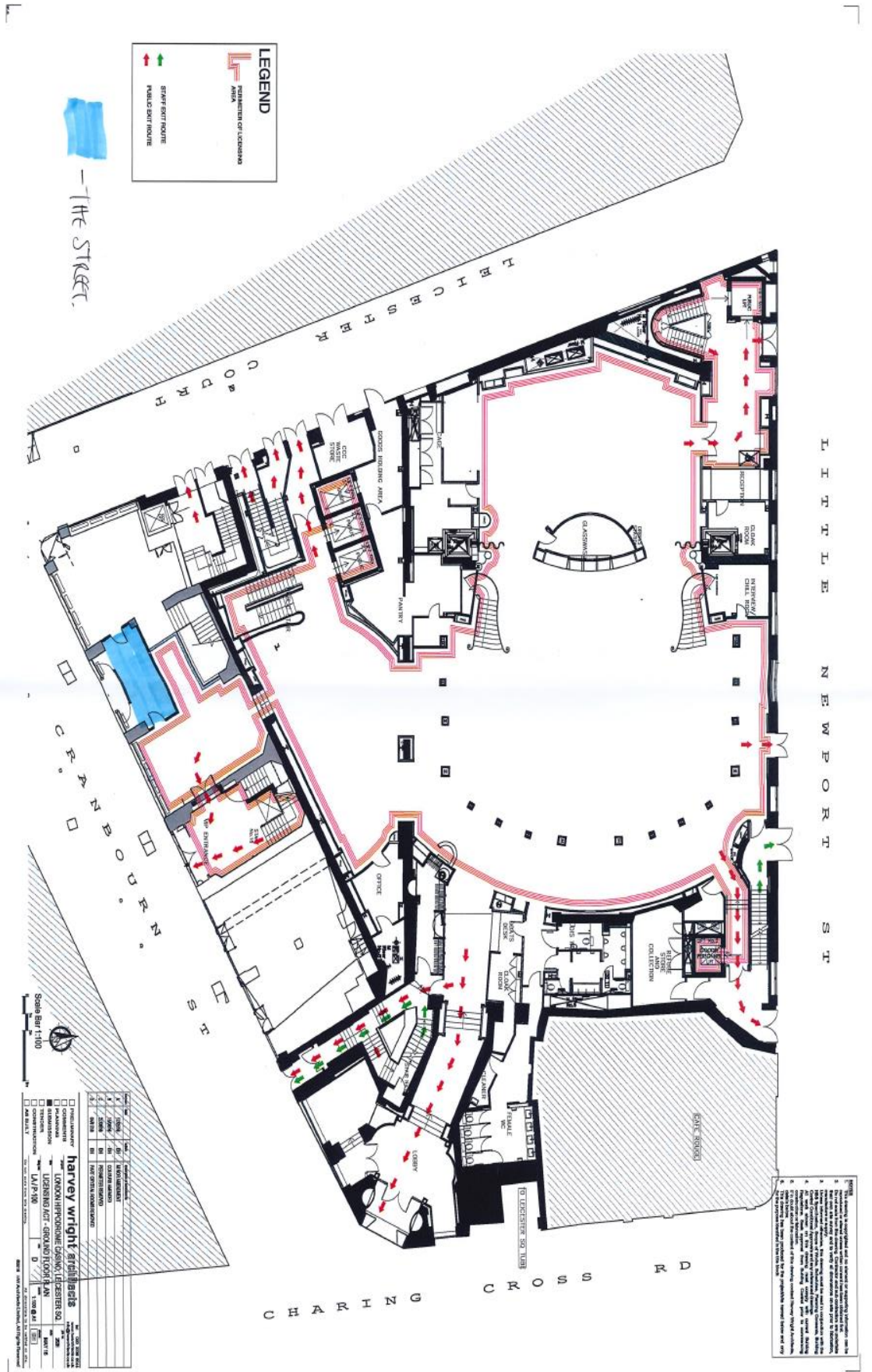



City of Westminster

Schedule 12  
Part B

WARD: St James's  
UPRN: 010033600458

Premises licence  
summary

Regulation 33, 34

Premises licence number:

18/13760/LIPVM

**Part 1 – Premises details**

**Postal address of premises:**

Hippodrome Casino  
The Hippodrome  
10-14 Cranbourn Street  
London  
WC2H 7JH

**Telephone Number:** Not Supplied

**Where the licence is time limited, the dates:**

Not applicable

**Licensable activities authorised by the licence:**

Performance of Dance  
Exhibition of a Film  
Indoor Sporting Event  
Performance of Live Music  
Playing of Recorded Music  
Anything of a similar description to Live Music, Recorded Music or Performance of Dance  
Performance of a Play  
Late Night Refreshment  
Sale by Retail of Alcohol

**The times the licence authorises the carrying out of licensable activities:**

**Performance of Dance**

Monday to Sunday: 00:01 to 00:00

**Exhibition of a Film**

Monday to Sunday: 00:01 to 00:00

**Indoor Sporting Event**

Monday to Sunday: 00:01 to 00:00

**Performance of Live Music**

Monday to Sunday: 00:01 to 00:00

**Playing of Recorded Music**

Monday to Sunday: 00:01 to 00:00

|  |                |
|--|----------------|
| <b>Anything of a similar description to Live Music, Recorded Music or Performance of Dance</b> |                |
| Monday to Sunday:  | 00:01 to 00:00 |
| <b>Performance of a Play</b>   |                |
| Monday to Sunday:  | 00:01 to 00:00 |
| <b>Late Night Refreshment</b>  |                |
| Monday to Sunday:  | 23:00 to 05:00 |
| <b>Sale by Retail of Alcohol</b>   |                |
| Monday to Sunday:  | 00:01 to 00:00 |

|   |                |
|---|----------------|
| <b>The opening hours of the premises:</b> |                |
| Monday to Sunday:                         | 00:01 to 00:00 |

**Where the licence authorises supplies of alcohol, whether these are on and/or off supplies:**

Alcohol is supplied for consumption on the Premises and off the premises as per condition 52 only.

**Name and (registered) address of holder of premises licence:**

Hippodrome Casino Limited  
Hippodrome Casino  
Cranbourne Street  
Leicester Square  
London  
WC2H 7JH

**Registered number of holder, for example company number, charity number (where applicable)**

05497987

**Name of designated premises supervisor where the premises licence authorises for the supply of alcohol:**

**Name:** Iain Stuart Peebles

**State whether access to the premises by children is restricted or prohibited:**

Prohibited

**Date:** 25 March 2019

**This licence has been authorised by Mr Kevin Jackaman on behalf of the Director - Public Protection and Licensing.**

**Applicant Supporting Documents**

**Appendix 2**

None submitted



**Documents submitted by the  
Metropolitan Police Service**

**Appendix 3**

Crimes reported to Police for **Cranbourn Street** for the period January 1<sup>st</sup> 2019 to 30<sup>th</sup> April 2019 – 4 month period

|   |            |
|---|------------|
| Theft                                   | 105        |
| GBH Assault                             | 7          |
| ABH Assault                             | 10         |
| Common Assault                          | 6          |
| Assault on Constable                    | 1          |
| Affray                                  | 1          |
| S4a Public Order<br>Street Disorder etc | 3          |
| Possession cannabis                     | 9          |
| Counterfeit/ forgery                    | 2          |
| Robbery                                 | 5          |
| Racial Harassment                       | 1          |
| Theft from vehicle                      | 1          |
| Public Decency                          | 1          |
| Criminal damage                         | 3          |
| Offensive weapon                        | 2          |
| Sexual Assault                          | 2          |
| <b>TOTAL CRIMES</b>                     | <b>153</b> |

Compiled by

**Bryan Lewis PC4161CW  
Westminster Police Licensing Team  
Westminster City Council  
15<sup>th</sup> Flr 64 Victoria Street  
SW1E 6QP  
T0207 641 3347**

## Licence & Appeal History

| <b>Application</b> | <b>Details of Application</b>                                | <b>Date Determined</b> | <b>Decision</b>                   |
|--------------------|--|------------------------|-----------------------------------|
| 10/03842/LIPN      | New Premises Licence   | 22.07.2010             | Granted under delegated authority |
| 10/10350/LIPT      | Transfer: United Leisure Gaming Ltd to Hippodrome Casino Ltd | 17.01.2011             | Granted under delegated authority |
| 11/00616/LIPDPS    | Variation of DPS   | 16.02.2011             | Granted under delegated authority |
| 11/01152/LIPV      | Variation of Premises Licence: change of layout              | 23.03.2011             | Granted under delegated authority |
| 12/00069/LIPVM     | Minor Variation: change of layout                            | 31.01.2012             | Granted under delegated authority |
| 12/03245/LIPDPS    | Variation of DPS   | 27.06.2012             | Granted under delegated authority |
| 12/04695/LIPVM     | Minor Variation: Removal of conditions                       | 27.06.2012             | Refused                           |
| 12/05530/LIPVM     | Minor Variation: variation of condition                      | 19.07.2019             | Granted under delegated authority |
| 12/06259/LIPVM     | Minor Variation: Removal of conditions                       | 07.08.2012             | Granted under delegated authority |
| 12/07625/LIPVM     | Minor Variation: Updating conditions                         | 20.09.2012             | Granted under delegated authority |
| 13/00097/LIPVM     | Minor Variation: change of layout                            | 24.01.2013             | Granted under delegated authority |
| 13/02007/LIPVM     | Minor Variation: Variation of condition                      | 16.04.2013             | Granted under delegated authority |
| 13/03082/LIPDPS    | Variation of DPS   | 25.06.2013             | Granted under delegated authority |

|                 |   |            |                                    |
|-----------------|---|------------|------------------------------------|
| 13/03315/LIPV   | Variation of Premises Licence: Amend condition                            | 18.07.2013 | Refused by Licensing Sub Committee |
| 13/05917/LIPDPS | Variation of DPS  | 30.08.2013 | Granted under delegated authority  |
| 13/08176/LIPVM  | Minor Variation: Change of layout   | 05.11.2013 | Granted under delegated authority  |
| 14/00868/LIPDPS | Variation of DPS  | 26.02.2014 | Granted under delegated authority  |
| 14/01520/LIPVM  | Minor Variation: Change of layout   | 10.03.2014 | Granted under delegated authority  |
| 14/02722/LIPV   | Variation of Premises Licence: Change of layout                           | 23.05.2014 | Granted under delegated authority  |
| 14/03088/LIPV   | Variation of Premises Licence: To permit off sales                        | 23.05.2014 | Granted under delegated authority  |
| 14/07918/LIPV   | Variation of Premises Licence: Change of layout                           | 08.01.2015 | Granted under delegated authority  |
| 16/01023/LIPV   | Variation of Premises Licence; Change of layout/removal of off sales      | 03.03.2016 | Granted under delegated authority  |
| 16/06524/LIPVM  | Minor Variation: Change of layout   | 14.07.2016 | Refused                            |
| 16/06825/LIPV   | Variation of Premises Licence: Remove/update conditions                   | 20.02.2017 | Granted under delegated authority  |
| 16/07905/LIPVM  | Minor Variation: Change of layout   | 17.08.2016 | Granted under delegated authority  |
| 17/00454/LIPVM  | Minor Variation: Change of layout (3 <sup>rd</sup> Floor)                 | 17.02.2017 | Granted under delegated authority  |
| 18/01108/LIPVM  | Minor Variation: Reduction of licensed area                               | 15.02.2018 | Granted under delegated authority  |
| 18/03985/LIPV   | Variation of Premises Licence: Variation of conditions/restrict off sales | 31.05.2018 | Granted under delegated authority  |

|                |                                      |            |   |
|----------------|--------------------------------------|------------|---|
| 18/10373/LIPVM | Minor Variation:<br>Change of layout | 26.09.2018 | Granted under<br>delegated<br>authority |
| 18/13760/LIPVM | Minor Variation:<br>Change of layout | 27.11.2018 | Granted under<br>delegated<br>authority |

**There is no appeal history**

*CONDITIONS CONSISTENT WITH THE OPERATING SCHEDULE AND  
CONDITIONS PROPOSED BY A PARTY TO THE HEARING*

When determining an application for a new premises licence under the provisions of the Licensing Act 2003, the licensing authority must, unless it decides to reject the application, grant the licence subject to the conditions which are indicated as mandatory in this schedule.

At a hearing the licensing authority may, in addition, and having regard to any representations received, grant the licence subject to such conditions which are consistent with the operating schedule submitted by the applicant as part of their application, or alter or omit these conditions, or add any new condition to such extent as the licensing authority considers appropriate for the promotion of the licensing objectives.

This schedule lists those conditions which are consistent with the operating schedule, or proposed as appropriate for the promotion of the licensing objectives by a responsible authority or an interested party as indicated. These conditions have not been submitted by the licensing service but reflect the positions of the applicant, responsible authority or interested party and have not necessarily been agreed

**Conditions: On Current Licence -**

**Mandatory:**

1. No supply of alcohol may be made at a time when there is no designated premises supervisor in respect of this licence.
2. No supply of alcohol may be made at a time when the designated premises supervisor does not hold a personal licence or the personal licence is suspended.
3. Every supply of alcohol under this licence must be made or authorised by a person who holds a personal licence.
4.
  - (1) The responsible person must ensure that staff on relevant premises do not carry out, arrange or participate in any irresponsible promotions in relation to the premises.
  - (2) In this paragraph, an irresponsible promotion means any one or more of the following activities, or substantially similar activities, carried on for the purpose of encouraging the sale or supply of alcohol for consumption on the premises—
    - (a) games or other activities which require or encourage, or are designed to require or encourage, individuals to;
      - (i) drink a quantity of alcohol within a time limit (other than to drink alcohol sold or supplied on the premises before the cessation of the period in which the responsible person is authorised to sell or supply alcohol), or
      - (ii) drink as much alcohol as possible (whether within a time limit or otherwise);
    - (b) provision of unlimited or unspecified quantities of alcohol free or for a fixed or discounted fee to the public or to a group defined by a particular

characteristic in a manner which carries a significant risk of undermining a licensing objective;

- (c) provision of free or discounted alcohol or any other thing as a prize to encourage or reward the purchase and consumption of alcohol over a period of 24 hours or less in a manner which carries a significant risk of undermining a licensing objective;
  - (d) selling or supplying alcohol in association with promotional posters or flyers on, or in the vicinity of, the premises which can reasonably be considered to condone, encourage or glamorise anti-social behaviour or to refer to the effects of drunkenness in any favourable manner;
  - (e) dispensing alcohol directly by one person into the mouth of another (other than where that other person is unable to drink without assistance by reason of a disability).
5. The responsible person must ensure that free potable water is provided on request to customers where it is reasonably available.
6. (1) The premises licence holder or club premises certificate holder must ensure that an age verification policy is adopted in respect of the premises in relation to the sale or supply of alcohol.
- (2) The designated premises supervisor in relation to the premises licence must ensure that the supply of alcohol at the premises is carried on in accordance with the age verification policy.
- (3) The policy must require individuals who appear to the responsible person to be under 18 years of age (or such older age as may be specified in the policy) to produce on request, before being served alcohol, identification bearing their photograph, date of birth and either—
- (a) a holographic mark, or
  - (b) an ultraviolet feature.
7. The responsible person must ensure that—
- (a) where any of the following alcoholic drinks is sold or supplied for consumption on the premises (other than alcoholic drinks sold or supplied having been made up in advance ready for sale or supply in a securely closed container) it is available to customers in the following measures—
    - (i) beer or cider: ½ pint;
    - (ii) gin, rum, vodka or whisky: 25 ml or 35 ml; and
    - (iii) still wine in a glass: 125 ml;
  - (b) these measures are displayed in a menu, price list or other printed material which is available to customers on the premises; and
  - (c) where a customer does not in relation to a sale of alcohol specify the quantity of alcohol to be sold, the customer is made aware that these measures are available.

A responsible person in relation to a licensed premises means the holder of the premises licence in respect of the premises, the designated premises supervisor (if any) or any individual aged 18 or over who is authorised by either the licence holder or designated premises supervisor. For premises with a club premises certificate, any member or officer of the club present on the premises in a capacity that which enables him to prevent the supply of alcohol.

8(i) A relevant person shall ensure that no alcohol is sold or supplied for consumption on or off the premises for a price which is less than the permitted price.

8(ii) For the purposes of the condition set out in paragraph 8(i) above -

(a) "duty" is to be construed in accordance with the Alcoholic Liquor Duties Act 1979;

(b) "permitted price" is the price found by applying the formula -

$$P = D + (D \times V)$$

Where -

(i) P is the permitted price,

(ii) D is the amount of duty chargeable in relation to the alcohol as if the duty were charged on the date of the sale or supply of the alcohol, and

(iii) V is the rate of value added tax chargeable in relation to the alcohol as if the value added tax were charged on the date of the sale or supply of the alcohol;

(c) "relevant person" means, in relation to premises in respect of which there is in force a premises licence -

(i) the holder of the premises licence,

(ii) the designated premises supervisor (if any) in respect of such a licence, or

(iii) the personal licence holder who makes or authorises a supply of alcohol under such a licence;

(d) "relevant person" means, in relation to premises in respect of which there is in force a club premises certificate, any member or officer of the club present on the premises in a capacity which enables the member or officer to prevent the supply in question; and

(e) "value added tax" means value added tax charged in accordance with the Value Added Tax Act 1994.

8(iii). Where the permitted price given by Paragraph 8(ii)(b) above would (apart from this paragraph) not be a whole number of pennies, the price given by that sub-paragraph shall be taken to be the price actually given by that sub-paragraph rounded up to the nearest penny.

8(iv). (1) Sub-paragraph 8(iv)(2) below applies where the permitted price given by Paragraph 8(ii)(b) above on a day ("the first day") would be different from the permitted price on the next day ("the second day") as a result of a change to the rate of duty or value added tax.

(2) The permitted price which would apply on the first day applies to sales or supplies of alcohol which take place before the expiry of the period of 14 days beginning on the second day.

9. All persons guarding premises unauthorised access or occupation or against outbreaks of disorder or against damage (door supervisors) must be licensed by the Security Industry Authority).
10. Admission of children to the premises must be restricted in accordance with the film classification recommended by the British Board of Film Classification or recommended by this licensing authority as appropriate.

## **Annex 2 – Conditions consistent with the operating Schedule**

11. Where regulated entertainment involves special effects such as lasers or pyrotechnics, seven days prior notice shall be given to Westminster City Council Environmental Health Consultation Team.
  12. Door Supervisors will be deployed at the premises to monitor the entry and exit points whenever the premises are open after 21:00 hours.
  13. The premises shall comply with the appropriate provisions of the DSA Technical Standards for Places of Entertainment.
  14. Any Premises Licence granted under the Licensing Act 2003 in respect of this application (number 10/03842/LIPN) shall have no effect unless a Casino Licence is in force and any such Premises Licence shall be surrendered to the Licensing Authority if the Gaming Licence is no longer in force.
  15. A personal licence holder shall be on duty at the premises at all times when licensable activities are taking place.
  16. The sale and supply of alcohol and the provision of regulated entertainment shall be secondary to the provision of casino facilities.
  17. The supply of alcohol to the tables on the first floor will be by Waiter/waitress service, save for tables in the bar area.
  18. Substantial food and suitable beverages other than alcohol shall be available where licensable activities are taking place.
  19. The number of persons accommodated at any one time (including staff) shall not exceed the following:  
4th floor card deck: 110  
persons Auditorium Balcony:  
60 persons Cabaret balcony:  
110 persons 1st Floor  
Cabaret: 240 persons  
  
Remaining parts of premises: 2010 persons
- With a maximum capacity of 2530 persons (including staff) at any one time.
20. The operators of the business and/or the licensees shall ensure that any capacity limits set for the premises is properly monitored at all times. Information regarding the capacity shall be given to an authorised officer or Police Officer on request.



21. An attendant shall be on duty in the cloakroom during the whole time that it is in use.
22. A minimum of two door supervisors shall be on duty at all times when licensable activities are taking place.
23. The premises licence holder shall ensure that any queue to enter the premises which forms outside the premises is orderly and supervised by door staff so as to ensure that there is no public nuisance or obstruction to the public highway.
24. The venue will maintain a comprehensive CCTV system that ensures all parts of the licensed premises are monitored, including all entry and exit points and the street environment including the identification of every person entering in any light condition. All such cameras, that are not unique to casinos, required and approved by the Police and Licensing Authority shall continually record whilst the premises are open to the public and the recordings shall be retained and made available for 31 days with time and date stamping. Recordings shall be made available to an authorised officer or a Police officer together with facilities for viewing. The recordings for the preceding two days shall be made available on request. Recordings outside this period shall be made available at 24 hours notice. All recording imagery that is unique to casinos such as gaming surveillance and cash desk imagery will be retained for the periods prescribed by the Gambling Commission or in the absence of a defined time, in accordance with the existing procedure. Where there is doubt or overlap the longest period will apply. (Subject to Data Protection Act 1998)
25. A staff member from the premises who is conversant with the operation of the CCTV system shall be on the premises at all times when the premises are open to the public. This staff member shall be capable of showing Police recent data or footage with the absolute minimum of delay when required to do so.
26. Loudspeakers shall not be located in the entrance lobby areas.
27. Noise and/or vibration emanating from the premises or transmitted through the structure shall not be audible beyond the boundary of the premises at any time.
28. Notices shall be prominently displayed at exits requesting the public to respect the needs of local residents and to leave the premises and the area quietly.
29. The means of escape provided for the premises shall at all times be maintained unobstructed, free of trip hazards, be immediately available and clearly identified in accordance with the plans provided.
30. The approved arrangements at the premises, including means of escape provisions, emergency warning equipment, the electrical installation and mechanical equipment, shall at all times be maintained in good condition and full working order.
31. All exit doors shall be available at all times without the use of a key, code, card or similar means.

32. All emergency doors shall be maintained effectively self closing and not held open other than by an approved device.
33. The edges of the treads of steps and stairways shall be marked and maintained so as to be conspicuous at all times.
34. Curtains and hangings shall be arranged so as not to obstruct emergency signs.
35. The certificates listed below shall be submitted to the Licensing Authority upon written request.
36. Any special effects or mechanical installations shall be arranged and stored so as to minimise any risk to the safety of those using the premises. The following special effects will only be used on 10 days prior notice being given to the Licensing Authority where consent has not previously been given.
  - dry ice and cryogenic fog
  - smoke machines and fog generators
  - pyrotechnics including fire works
  - firearms
  - lasers
  - explosives and highly flammable substances
  - real flame
  - strobe lighting
37. Flashing or particularly bright lights on or outside the premises shall not cause a nuisance to nearby properties (save insofar as they are necessary for the prevention of crime).
38. No person shall give at the premises any exhibition, demonstration or performance of hypnotism, mesmerism or any similar act or process which produces or is intended to produce in any other person any form of induced sleep or trance in which susceptibility of the mind of that person to suggestion or direction is increased or intended to be increased.

NOTE: (1) This rule does not apply to exhibitions given under the provisions of Section 2(1A) and 5 of the Hypnotism Act 1952.

39. All waste is to be properly presented and placed out for collection no earlier than 30 minutes before the scheduled collection times.
40. No refuse, including bottles, shall be moved, removed or transferred to or in outside areas between 2300 hours and 0800hours.
41. All private and corporate events in the VIP rooms on the 3rd Floor and the private dining areas on the 2nd floor with more than 60 guests will be notified to Westminster Licensing Police giving a minimum of 10 working days notice. All such notifications shall include the following information: the date and time of the event, the duration of the event and the name of the organiser of the event. All such events shall not take place if so instructed by the Police.

42. Uniformed employees of the premises licence holder may be permitted to distribute flyers or leaflets advertising or promoting the premises or any of its events, facilities, goods or services, within 25 metres of any entrance to the Hippodrome Casino, but shall not do so in a manner which may cause an obstruction of the highway nor a nuisance to any passer-by.
43. The pavement within 25 metres of the entrances to the premises shall be kept free of litter or debris arising from the premises and its operation at all times to the satisfaction of the Council.
44. No flyers to be distributed after 21.00 hours or before 08.00 hours.
45. Any flyers distributed outside the premises shall contain no reference to any activity licensed at the premises for the purposes of the Sexual Entertainment licence.
46. Distributors of the flyers will operate a "Think 25" policy.
47. No more than two persons may distribute flyers at any one time.
48. No un-authorized advertisements of any kind (including placard, poster, sticker, flyer, picture, letter, sign or other mark) is inscribed or affixed upon the surface of the highway, or upon any building, structure, works, street furniture, tree, or any other property, or is distributed outside the premises to the public, that advertises or promotes the establishment, its premises, or any of its events, facilities, goods or services.
49. Gaming may take place in the basement and on ground, first, second, third and fourth floors. Cabaret will be limited to the designated area on the first floor. Designated restaurant and dining areas are located on first, second and third floors.
50. All alcohol served in the restaurant will be ancillary to food
51. The variation of the Premises Licence (14/07918/LIPV) to include (addition of double entrance doors to the lounge) will have no effect until the premises have been assessed as satisfactory by the Environmental Health Consultation Team and this condition has been removed from the Licence.
52. All sales of alcohol for consumption "off" the premises is restricted to:
  - (a) Sealed containers sold to invited customers of the Hippodrome Wine Club
  - (b) Patrons who are gaming within the adjacent Hippodrome Bingo premises supplied only through The Street (as shaded on plan reference LA/P-100 dated May 2016) by waiter/waitress service between 09.00 hours and 00.00 hours (Midnight) Monday to Sunday

**Condition 52 is proposed to be amended by the applicant so as to read:**

**All sales of alcohol for consumption “off” the premises is restricted to:**

- (a) Sealed containers sold to invited customers of the Hippodrome Wine Club**
- (b) Patrons who are gaming within the adjacent Hippodrome Bingo premises supplied only through The Street (as shaded on plan reference LA/P-100 dated May 2016) by waiter/waitress service 24 hours per day**

53. Patrons permitted to temporarily leave and then re-enter The Hippodrome Casino or Hippodrome Bingo, e.g. to smoke, shall not be permitted to take drinks or glass containers with them

**Annex 3 – Conditions attached after a hearing by the licensing authority**

None

**The Metropolitan Police Service have proposed the following condition in addition to those contained within the operating schedule**

54. All public entrances to the Hippodrome casino between 11pm and 6am shall be guarded by SIA security wearing high visibility yellow jackets or tabard



Resident Count:61

Licensed Premises within 75 Metres of 10-14 Cranbourn Street

| Licence Number  | Trading Name            | Address   | Premises Type              | Time Period   |
|-----------------|-------------------------|---|----------------------------|---|
| 18/13760/LIPVM  | Hippodrome Casino       | The Hippodrome<br>10 - 14<br>Cranbourn<br>Street London<br>WC2H 7JH | Casino or<br>gambling club | Monday to<br>Sunday; 00:01<br>- 00:00   |
| 19/01085/LIPDPS | PizzaExpress            | 43 Charing<br>Cross Road<br>London WC2H<br>0AP                      | Restaurant                 | Monday to<br>Saturday;<br>07:00 - 00:30  <br>Sunday; 07:00<br>- 00:00  <br>Sundays<br>before Bank<br>Holidays;<br>07:00 - 00:30 |
| 18/08680/LIPVM  | Vue Cinemas<br>West End | 3 Cranbourn<br>Street London<br>WC2H 7AL                            | Cinema                     | Monday to<br>Sunday; 00:00<br>- 00:00   |
| 18/06273/LIPDPS | Vue Cinemas<br>West End | 3 Cranbourn<br>Street London<br>WC2H 7AL                            | Cinema                     | Monday to<br>Sunday; 00:00<br>- 00:00   |

|                 |                          |  |              |  |
|-----------------|--------------------------|--|--------------|--|
| 18/03438/LIPV   | Cafe Fiori               | 42 Cranbourn Street London WC2H 7AN                                | Cafe         | Monday to Saturday;<br>10:00 - 05:00  <br>Sunday; 12:00 - 05:00  |
| 18/04929/LIPN   | Kaya                     | 10 Little Newport Street London WC2H 7JJ                           | Not Recorded | Monday to Sunday; 10:00 - 23:30  |
| 09/02405/LIPV   | Noodle Stop              | Ground 44-46 Cranbourn Street London WC2H 7AN                      | Restaurant   | Monday to Saturday;<br>10:00 - 05:00  <br>Sunday; 12:00 - 05:00  |
| 10/07083/LIPT   | Cork And Bottle Wine Bar | Basement 44-46 Cranbourn Street London WC2H 7AN                    | Wine bar     | Monday to Saturday;<br>10:00 - 00:30  <br>Sunday; 12:00 - 00:00  |
| 18/08104/LIPDPS | Baiwei Restaurant        | 8 Little Newport Street London WC2H 7JJ                            | Restaurant   | Monday to Saturday;<br>10:00 - 00:30  <br>Sunday; 12:00 - 00:00  |
| 08/07461/LIPT   | Rimini Coffee Bar        | Basement And Ground Floor West 47 Cranbourn Street London WC2H 7AN | Cafe         | Monday to Thursday;<br>10:00 - 02:00  <br>Monday to Thursday;<br>10:00 - 02:00  <br>Friday to Saturday;<br>10:00 - 04:00  <br>Friday to Saturday;<br>10:00 - 03:00  <br>Sunday; 12:00 - 02:00  <br>Sunday; 12:00 - 01:30 |
| 06/12504/WCCMAP | Tokyo Diner              | 2 Newport Place London WC2H 7JP                                    | Restaurant   | Monday to Saturday;<br>10:00 - 00:30  <br>Sunday; 12:00 - 00:00  |
| 13/08732/LIPDPS | Longji                   | Ground 47 Charing Cross Road London WC2H 0AN                       | Restaurant   | Monday to Sunday; 11:00 - 23:30  |

|                 |                        |  |                               |   |
|-----------------|------------------------|--|-------------------------------|---|
| 17/03178/LIPDPS | Bella Italia           | 1 Cranbourn Street London WC2H 7AJ                                 | Restaurant                    | Monday to Saturday; 09:00 - 01:00   Sunday; 09:00 - 00:00   Sundays before Bank Holidays; 09:00 - 01:00   |
| 19/03746/LIPDPS | Baozi Inn              | 25-26 Newport Court London WC2H 7JS                                | Restaurant                    | Monday to Friday; 10:00 - 23:30   Saturday; 10:00 - 00:30   Sunday; 10:00 - 23:00   |
| 17/01541/LIPN   | Gourmet Kitchen        | 34 Lisle Street London WC2H 7BD                                    | Restaurant                    | Monday to Thursday; 10:00 - 00:00   Friday to Saturday; 10:00 - 00:30   Sunday; 12:00 - 23:00   Sundays before Bank Holidays; 12:00 - 00:30   New Year's Eve; 00:00 - 00:00                             |
| 16/11211/LIPT   | American Fried Chicken | 16A Leicester Square London WC2H 7LE                               | Restaurant                    | Monday to Thursday; 23:00 - 00:00   Friday to Sunday; 23:00 - 02:30   |
| 18/08641/LIPV   | Essentials             | Unit 1 Leicester Square Station Charing Cross Road London WC2H 0AP | Kiosk within another property | Monday to Sunday; 07:00 - 22:00   |
| 16/11554/LIPVM  | Ku Bar                 | 29 - 30 Lisle Street London WC2H 7BA                               | Night clubs and discos        | Monday to Thursday; 10:00 - 23:30   Monday to Saturday; 09:00 - 03:30   Friday to Saturday; 10:00 - 00:00   Sunday; 09:00 - 00:30   Sunday; 12:00 - 22:30   Sundays before Bank Holidays; 12:00 - 00:00 |

|                 |                                |  |                                  |   |
|-----------------|--------------------------------|--|----------------------------------|---|
| 16/03237/LIPV   | The Brewmaster                 | 37 Cranbourn Street London WC2H 7AD                            | Pub or pub restaurant with lodge | Monday to Thursday; 08:00 - 23:30   Friday to Saturday; 08:00 - 00:30   Sunday; 08:00 - 23:00   |
| 19/02953/LIPDPS | The Porcupine Public House     | 48 Charing Cross Road London WC2H 0BS                          | Public house or pub restaurant   | Monday to Thursday; 07:00 - 23:30   Monday to Saturday; 07:00 - 00:30   Friday to Saturday; 07:00 - 00:00   Sunday; 07:00 - 00:00   Sunday; 07:00 - 22:30   Sundays before Bank Holidays; 07:00 - 00:00 |
| 13/04940/LIPDPS | Zoo Too                        | 18 Bear Street London WC2H 7AX                                 | Pub or pub restaurant with lodge | Monday to Wednesday; 10:00 - 00:00   Thursday; 10:00 - 01:00   Friday to Saturday; 10:00 - 02:00   Sunday; 12:00 - 23:00  |
| 19/00097/LIPCH  | Maison Du Mezze                | Ground Floor Victory House 14 Leicester Square London WC2H 7NG | Restaurant                       | Monday to Saturday; 10:00 - 03:00   Sunday; 12:00 - 01:00   |
| 19/02861/LIPCH  | Platinum Lace Leicester Square | Basement Victory House 14 Leicester Square London WC2H 7NG     | Sexual Entertainment Venue       | Monday to Saturday; 17:00 - 06:00   Sunday; 17:00 - 03:00   Sundays before Bank Holidays; 17:00 - 06:00   |



|                |                      |   |                        |   |
|----------------|----------------------|---|------------------------|---|
| 19/02786/LIPVM | Leongs Legend II     | 26 - 27 Lisle Street London WC2H 7BA                                      | Restaurant             | Monday; 10:00 - 00:30   Tuesday; 10:00 - 00:30   Wednesday; 10:00 - 00:30   Thursday; 10:00 - 00:30   Friday; 10:00 - 00:30   Saturday; 10:00 - 00:30   Sunday; 10:00 - 00:30 |
| 15/06521/LIPVM | The Zoo Bar And Club | Basement And Ground Floor Cameo House 13 - 17 Bear Street London WC2H 7AS | Night clubs and discos | Monday to Saturday; 09:00 - 03:30   Monday to Saturday; 09:00 - 02:30   Sunday; 09:00 - 01:00   Sundays before Bank Holidays; 09:00 - 02:30                                   |
| 17/07548/LIPVM | Burger King          | 17-18 Leicester Square London WC2H 7LE                                    | Restaurant             | Monday to Sunday; 23:00 - 03:00   |
| 17/05123/LIPVM | Pizza Hut            | 19 Leicester Square London WC2H 7LE                                       | Restaurant             | Monday to Thursday; 10:00 - 02:00   Friday to Saturday; 10:00 - 05:00   Sunday; 12:00 - 02:00   |

|                 |                                     |   |                                   |  |
|-----------------|-------------------------------------|---|-----------------------------------|--|
| 18/05898/LIPDPS | Bear & Staff<br>Public House        | 10 - 12 Bear<br>Street London<br>WC2H 7AX                       | Public house or<br>pub restaurant | Monday to<br>Thursday; 07:00<br>- 23:30  <br>Monday to<br>Saturday; 07:00<br>- 00:30   Friday<br>to Saturday;<br>07:00 - 00:00  <br>Sunday; 07:00 -<br>22:30   Sunday;<br>07:00 - 00:00  <br>Sundays before<br>Bank Holidays;<br>07:00 - 00:00 |
| 17/14404/LIPDPS | Wyndhams<br>Theatre                 | Wyndhams<br>Theatre Charing<br>Cross Road<br>London WC2H<br>0DA | Theatre                           | Monday to<br>Sunday; 09:00 -<br>01:00  |
| 11/06219/LIPT   | Abeno Too<br>Japanese<br>Restaurant | 15 - 18 Great<br>Newport Street<br>London WC2H<br>7JE           | Restaurant                        | Monday to<br>Wednesday;<br>12:00 - 23:00  <br>Wednesday to<br>Saturday; 12:00<br>- 23:30  <br>Sunday; 12:00 -<br>22:30   |
| 10/08059/LIPDPS | Pizza Rico                          | 15 - 18 Great<br>Newport Street<br>London WC2H<br>7JE           | Restaurant                        | Monday to<br>Sunday; 07:00 -<br>00:30  |